

## **Guidelines for the use of Summers Field**

When Friends of Summers Field was formed in 2011 it was on the basis of establishing a community orchard and wildflower meadow for use by the whole community of Doynton. This is the basis on which South Gloucestershire Council granted licences for use of the field and must be the primary purpose for which it is used.

Having said that, it was always planned that there would be social and recreational use of the field as part of this purpose and a social area was included in the design as a result of this.

Based on the above, the following guidelines should be followed by all members of the community using the field:

- Dog walkers are welcome to use the field, but please ensure your dog is kept on a lead if there is any risk of it interfering with other dogs or people using the field. Please also ensure that you clear up and remove any mess your dog may leave.
- Children are welcome to play in the field, but please bear in mind its primary use as an orchard and wildflower meadow. Damage can easily be caused to the trees and other users of the field may be there to enjoy the peace and tranquillity. The field is not licensed or insured for use as a playing field as such - facilities for this are provided in the Playing Field on Toghill Lane.
- The social area will be kept mown so that it can be used for family picnics, social and community gatherings. Please ensure that you remove any rubbish after using the area.
- Once the trees have matured and start bearing fruit, work parties and events will be arranged to harvest the fruit and distribute it around the community. Please do not harvest the fruit outside these work parties and events.
- When the wildflower meadow has been established, paths through the area will be mown to allow access. Please follow these paths and do not walk through the un-mown areas.
- Apart from the restrictions outlined above access to the field will be open, but please use the footpaths if you are just crossing the field to access the land beyond it. Please also note that the only public footpath is the one following the North boundary – the footpath from the entrance gate to the stile in the North East corner of the field is a permissive path only.

Friends of Summers Field Management Committee

May 2013

# SUMMERS FIELD COMMUNITY ORCHARD AND WILDFLOWER MEADOW

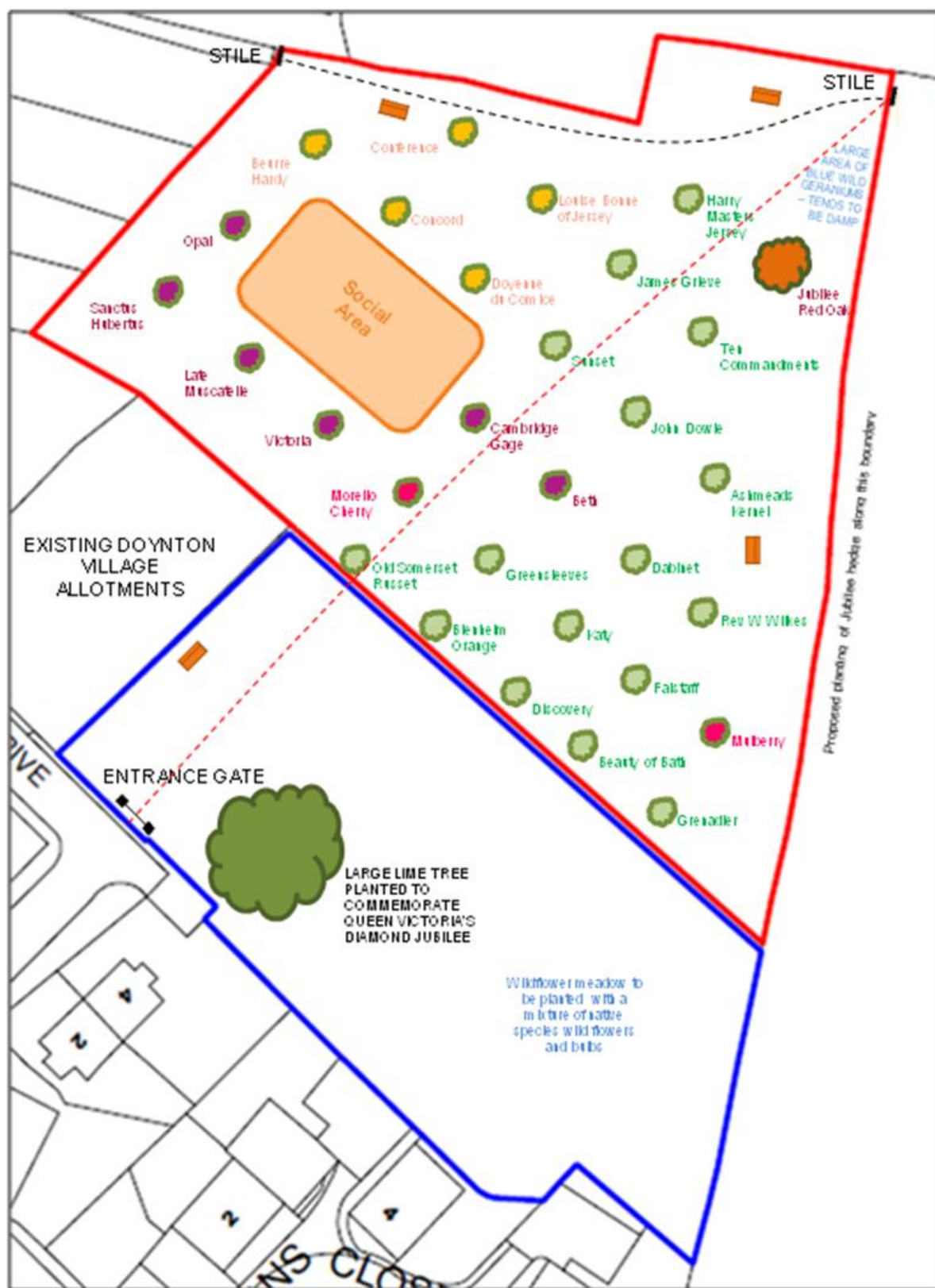

- |                     |                  |             |
|---------------------|------------------|-------------|
| Orchard             | Apple            | Social Area |
| Wildflower Meadow   | Plum/Greengage   | Oak Bench   |
| Public Right of Way | Pear             |             |
| Permissive Path     | Mulberry/Morello |             |