



## Friends of Summers Field

It's a long time since the public meeting last January when all present agreed that we should proceed to rent the field from South Gloucestershire Council in order to get the community orchard and wildflower meadow off the ground.

Unfortunately it took until May and the involvement of Cllr Stephen Reade to get any engagement from the Council property department. Terms were eventually agreed and documents signed in July. These give us an annual licence for the wildflower meadow, but a seven year licence for the orchard, allowing time for the orchard to be established.

The biggest issue was the £1400 in fees SGC wanted to charge. This was negotiated down to £750, £500 payable on execution of the licences and £250 by 31<sup>st</sup> March next year. When added to the first year's rent (payable in advance) this means we have had to spend all the money raised so far, so further fundraising is needed.

An application for a further capital grant from SGC has been made and applications for grants have also been submitted to National Lottery Awards For All and Quartet Community Foundation. The orchard and wildflower meadow meet the qualifying criteria for all these applications, but we have yet to hear whether any of them have been successful. In the meantime the capital grant secured from SGC last year has been spent on four oak benches which will be installed in the field.

With no guarantee of success for any of the current grant applications we are asking for further donations. A proposed design has been completed (attached) and preliminary pricing indicates a cost of £40 per tree including tree guards, stakes, etc. On that basis we are asking residents to sponsor trees at £40 each or make a general donation. Anybody wishing to do so is asked to complete the attached response form and return it to me. As FoSF now has Charitable Status a Gift Aid form is also attached. Please complete this and send it with your response form and cheque if you are a UK taxpayer – this will allow us to claim back tax from HMRC. Please can anyone who has previously made a donation also complete one of these forms even if you do not wish to make a further donation, as we can claim back tax retrospectively.



As agreed at the meeting last January all residents living next to the field will be consulted on a face to face basis before the design is finalised.

Sandy Higgins

08/08/2012

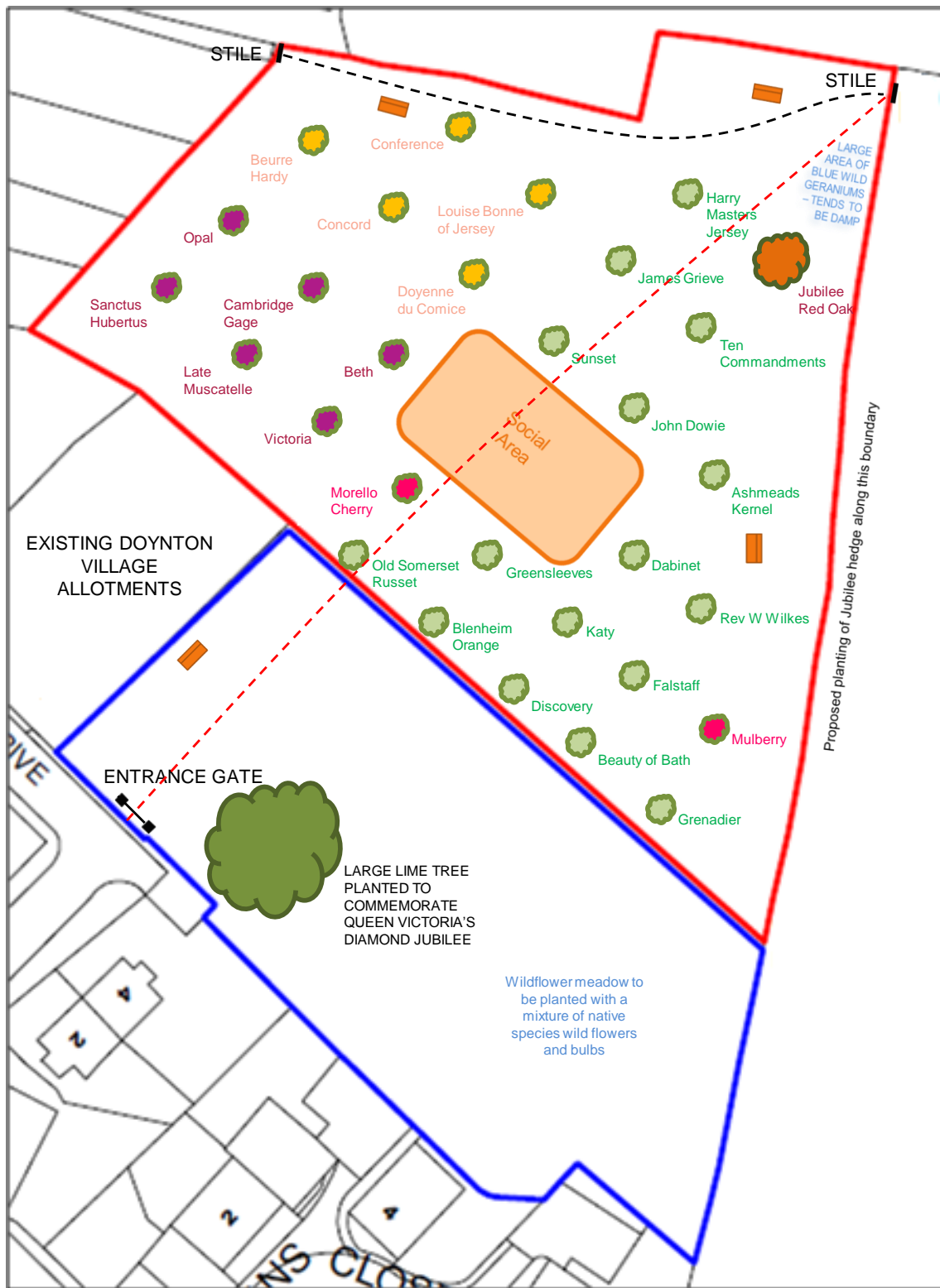
# PROPOSED DESIGN OF SUMMERS FIELD ORCHARD AND WILDFLOWER MEADOW



- |   |                     |   |                  |   |             |
|---|---------------------|---|------------------|---|-------------|
|  | Orchard             |  | Apple            |  | Social Area |
|  | Wildflower Meadow   |  | Plum/Greengage   |  | Oak Bench   |
|  | Public Right of Way |  | Pear             |   |             |
|  | Desire Line         |  | Mulberry/Morello |   |             |
- © C Wakefield-Wylde 2012

# Friends of Summers Field

## Response Form

Please complete the relevant section(s) and return to Sandy Higgins at Hill View, Church Road, Doynton BS30 5SU.

### **Tree Sponsorship**

I wish to sponsor .... trees and enclose a cheque for £..... at £40 each payable to Friends of Summers Field Ltd.

### **General Donation**

I wish to make a general donation of £..... to the Community Orchard and Wildflower project and enclose a cheque for this amount payable to Friends of Summers Field Ltd.

### **Gift Aid**

I am a UK taxpayer and attach a completed Gift Aid form

I am not a UK taxpayer

Name: .....

Address: .....

.....

.....

Tel No: .....

Email: .....

*giftaid it*

**Gift Aid declaration – for past, present & future donations**

To: Friends of Summers Field Limited

Please treat as Gift Aid donations all qualifying gifts of money made

today  in the past 4 years  in the future

Please tick all boxes you wish to apply.

I confirm I have paid or will pay an amount of Income Tax and/or Capital Gains Tax for each tax year (6 April to 5 April) that is at least equal to the amount of tax that all the charities or Community Amateur Sports Clubs (CASCs) that I donate to will reclaim on my gifts for that tax year. I understand that other taxes such as VAT and Council Tax do not qualify. I understand the charity will reclaim 28p of tax on every £1 that I gave up to 5 April 2008 and will reclaim 25p of tax on every £1 that I give on or after 6 April 2008.

Donor's details

Title \_\_\_\_\_ name or initial(s) \_\_\_\_\_

Surname \_\_\_\_\_

Full home address \_\_\_\_\_

\_\_\_\_\_

Postcode \_\_\_\_\_

Date \_\_\_\_\_

Signature \_\_\_\_\_

Please notify Friends of Summers Field Limited if you:

- Want to cancel this declaration
- Change your name or home address
- No longer pay sufficient tax on your income and/or capital gains.

If you pay Income Tax at the higher or additional rate and want to receive the additional tax relief due to you, you must include all your Gift Aid donations on your Self Assessment tax return or ask HM Revenue and Customs to adjust your tax code.